

Moving the Clock Connector Cover Plate

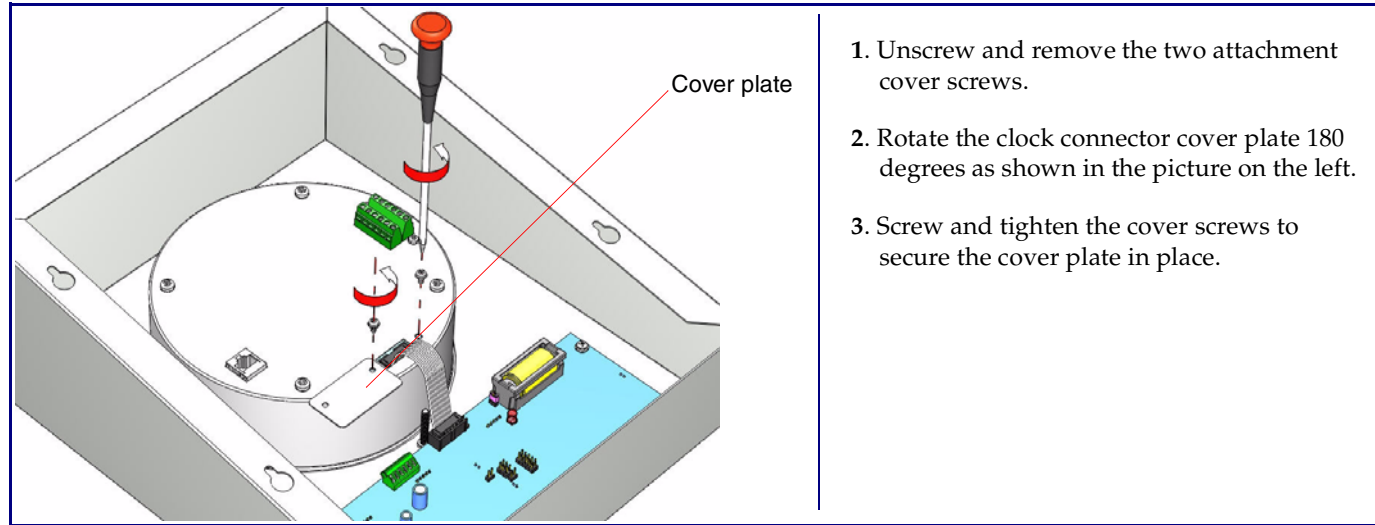

1. Unscrew and remove the two attachment cover screws.
2. Rotate the clock connector cover plate 180 degrees as shown in the picture on the left.
3. Screw and tighten the cover screws to secure the cover plate in place.

Connecting Power (optional power injector)

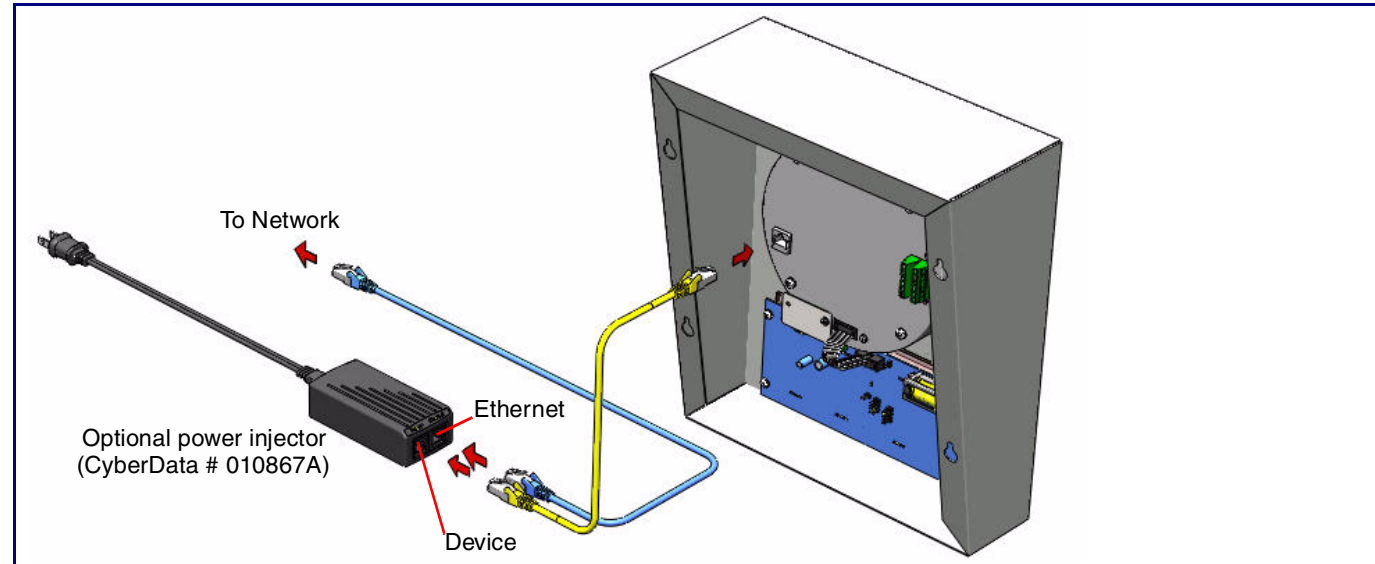

Connecting Power (PoE)

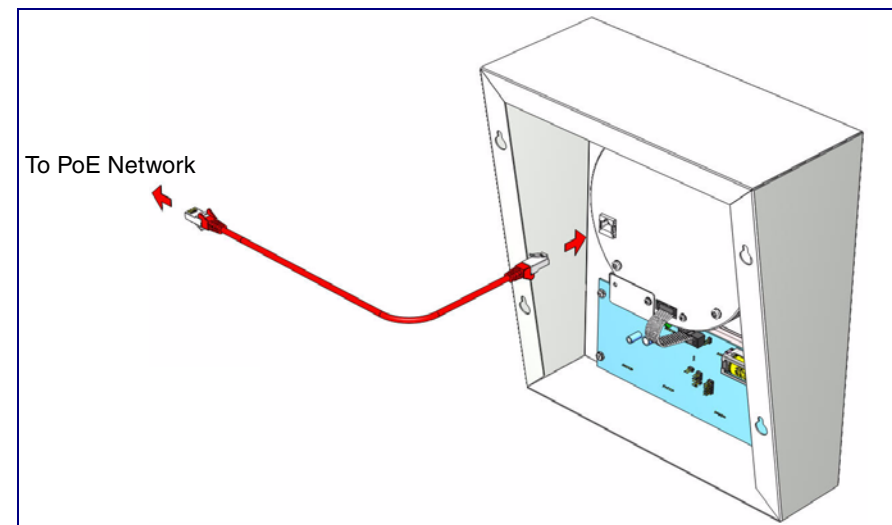

Contacting CyberData

Corporate Headquarters

CyberData Corporation
2555 Garden Road
Monterey, CA 93940, USA

Phone: 831-373-2601
Fax: 831-373-4193
www.CyberData.net

Sales: (831) 373-2601 ext. 334
Support: 831-373-2601 ext. 333
Email: support@CyberData.net
RMA Dept: (831) 373-2601 ext. 136
Email: RMA@CyberData.net
Warranty information available at:
<http://www.CyberData.net/index.html>



Installation Quick Reference

Clock Kit Wall Mount Adapter for Indoor Paging Speakers

011100*, RAL 9002, Gray White, Standard
011101, RAL 9003, Signal White, Optional

*Replaces the 011023 number.

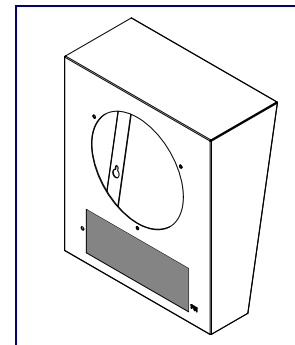

The Clock Kit Wall Mount Adapter enables the CyberData V2 VoIP Ceiling Speaker to be upgraded to a highly visible public address device with a time display.

The large display characters are easily read and adjust for ambient light conditions. Time sync is performed by NTP and a built-in real-time clock.

Power is supplied by the CyberData V2 Speaker from a single PoE connection.

The documentation for this product is released in an English language version only. You can download PDF copies of CyberData product documentation at:

<http://www.cyberdata.net/products/voip/digitalanalog/clockkit/docs.html>

Wall Mount Adapter Parts

(1) Wall Mount Adapter

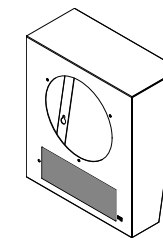

(1) Template for Wall Mount Adapter and Screw Holes*

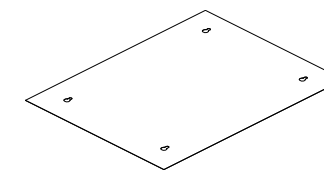

(1) Drywall Mounting Kit

(4) Plastic Ribbed Anchors

(4) #6 Sheet Metal Screws



**Note: the ceiling speaker wall-mounted adapter screws will be included in the ceiling speaker kit.*

Install Jumper JP1 Prior to Installing the Clock Kit

Make sure that jumper JP1 is installed prior to installing the Clock Kit (see the picture on the right). Installing JP1 powers the Real Time Clock from the battery. If you do not install JP1, the clock will lose its time when the power is disconnected.

Jumper Functions:

Jumper	Function
JP1	Battery - Connect
JP2	Manufacturing - Open
JP3	Manufacturing - Open
JP4	Manufacturing - Open
JP5	Manufacturing - Open

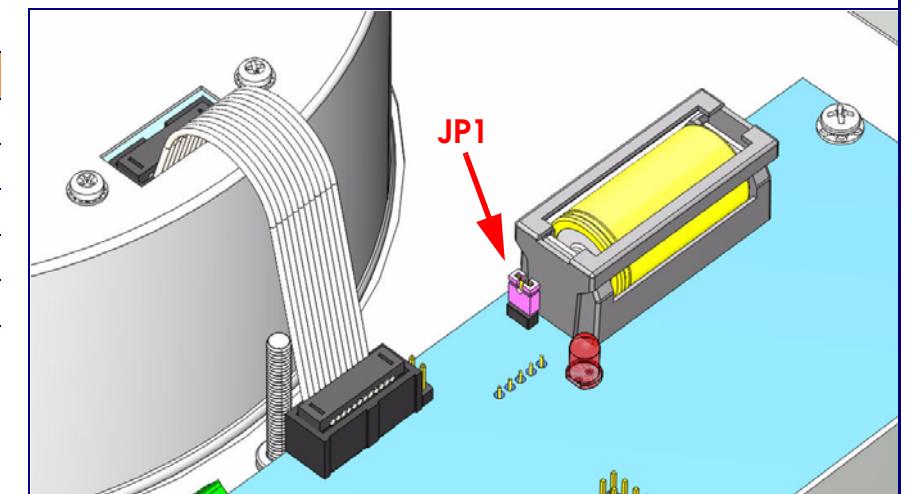

Mounting

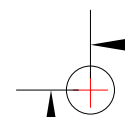

7.00 [177.8]



10.70 [271.8]

Dimensions are in Inches [mm]

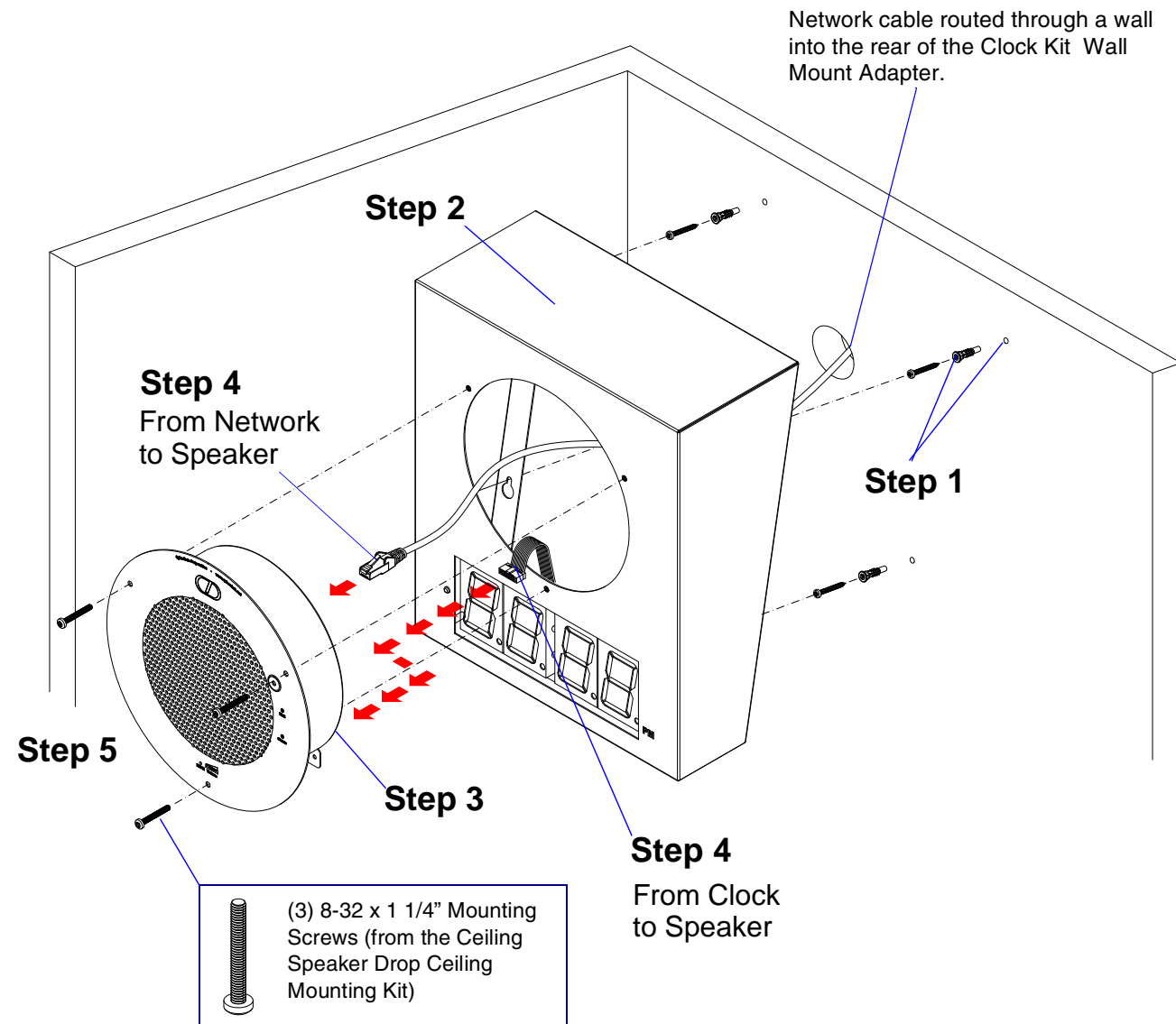

To mount a Clock Kit Wall Mount Adapter:

1. Use the **TEMPLATE** on this document to drill four holes in the wall for the anchors and screws.
 - Place the four **PLASTIC RIBBED ANCHORS** into the holes you prepared.
 - Screw the four **#6 SHEET METAL SCREWS** into the four **PLASTIC RIBBED ANCHORS**.
2. Position the **CLOCK KIT WALL MOUNT ADAPTER** over the four **#6 SHEET METAL SCREWS**.
3. Move the **CLOCK CONNECTOR COVER PLATE**. See the back of this placemat for details.
4. Connect Cables to the **IP SPEAKER ASSEMBLY**:
 - Plug the ribbon cable from the clock into the **IP SPEAKER ASSEMBLY**.
 - Plug the Ethernet cable from the network into the **IP SPEAKER ASSEMBLY**. The yellow light verifies the network connection. See the back of this placemat for details.

Note: You can route the Ethernet cable through the back or through the slots at the top or bottom of the **WALL MOUNT ADAPTER**.

5. Position the **IP SPEAKER ASSEMBLY** into the **CLOCK KIT WALL MOUNT ADAPTER** so that the **IP SPEAKER ASSEMBLY** screw holes align with the mounting holes in the **CLOCK KIT WALL MOUNT ADAPTER**.
 - Use three **8-32 x 1 1/4" MOUNTING SCREWS** (from the Ceiling Speaker Drop Ceiling Mounting Kit) to secure the **IP SPEAKER ASSEMBLY** to the **WALL MOUNT ADAPTER**.

Features

CyberData Part #011098 or #011099

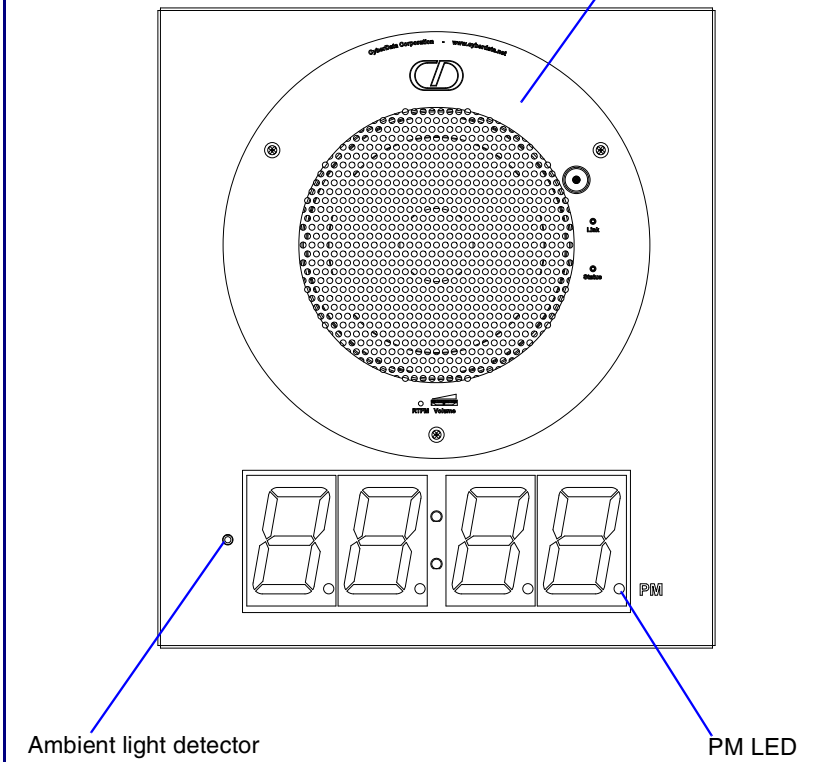

Dimensions

